

- 2772 IFAG FELLESTAND**
- \*02 ROC LA DANMARK
  - \*03 TOYOTA MATERIALE HANDLING
  - \*04 WALSTED TRUCK
  - \*05 N.NIELSEN
  - \*06 TEKTRA
  - \*07 ATLET DANMARK
  - \*08 JUNGHEINRICH DANMARK
  - \*09 DANTRUCK

- 2744 MOBILITY**
- \*01 KEZMOBILITY
  - \*02 ZEBRA TECHNOLOGIES EUROPE
  - \*03 PRINNO VIBORG
  - \*04 OPTIDEV
  - \*05 MOTOROLA SOLUTIONS DANMARK

- 2742 FA INSPIRATION TIL DIN LOGSTIK**
- \*01 PCSIS
  - \*02 INDUSTRIAL BARCODE SOLUTIONS
  - \*03 LOGSYS+AAM DANMARK
  - \*04
  - \*05 ADC SOLUTIONS
  - \*06 LYGSGE SYSTEMS
  - \*07 GSI DANMARK
  - \*08 LEXIT GRUPP DENMARK

# "TEST EN ELBIL"

## ChooseEV



**PORT**  
H: 445 cm.  
B: 560 cm.

**PORT**  
HH: 445 cm.  
BB: 560 cm.

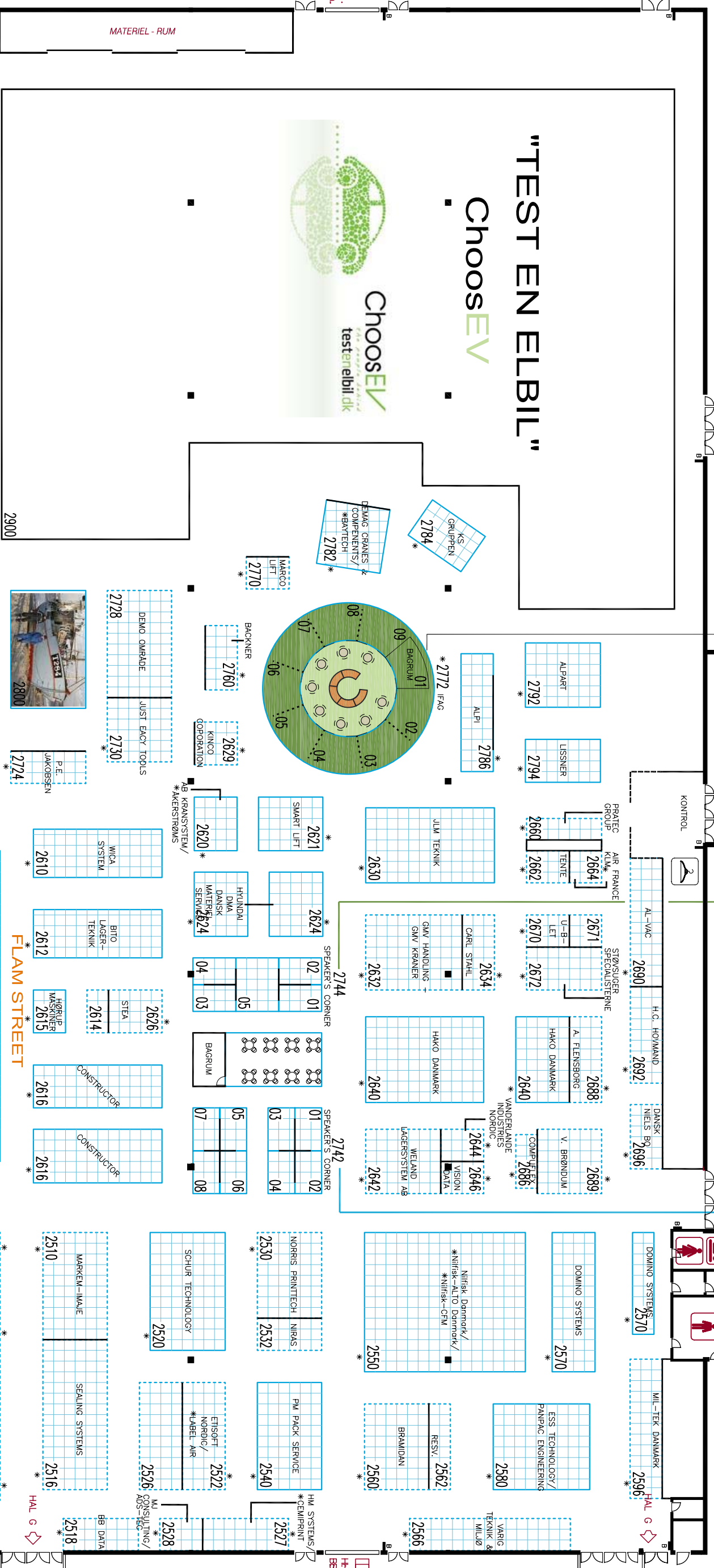

**hi [11]**  
THE SCANDINAVIAN INDUSTRY EXPO

**MCH** MESSCENTER HERNING KONGRESSENTER  
**Hal C**  
Møtlohold : 1 : 400  
Revideret : 31.08.11  
Tegn. af : HLY  
Vardevej 1 · DK-7400 Herning · mch.dk · T. +45 99 26 99 26 · F. Teknisk service +45 99 26 99 01

6.-9. september 2011 | hi11.dk